

JUNIOR PA MAYFLOWER

Society of Mayflower Descendants in the Commonwealth of Pennsylvania

VOL. 11 NO. 2

WWW.SAIL1620.ORG

SUMMER 2011

THOMAS ROGERS, LEIDEN GREYN WEAVER

a Pilgrim not covered in this series so far is Thomas Rogers. He was a son of William and Eleanor Rogers and apparently was born in Watford, Northamptonshire, England around 1572. In 1597 he married there Alice Cosford, a daughter of George Cosford. The parish registers there record the baptisms of six children: Thomas and Richard who died young, Joseph, John, Elizabeth and Margaret. To date descendants have only been found for Joseph and John.

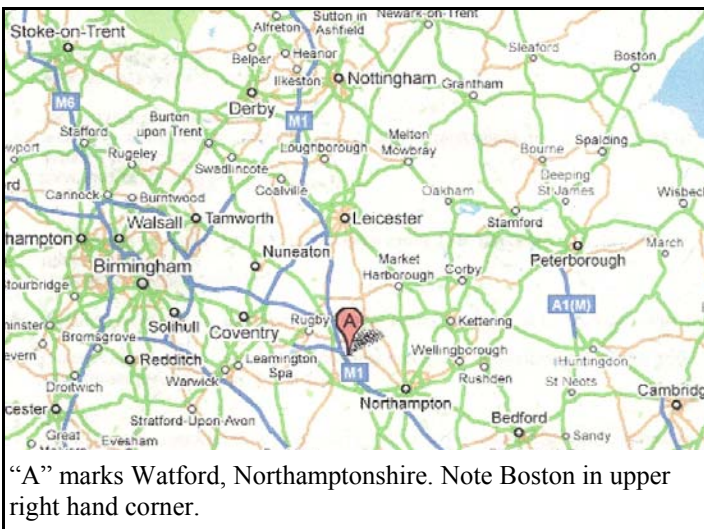

“A” marks Watford, Northamptonshire. Note Boston in upper right hand corner.

Leiden, Holland records show that Thomas purchased a

house in 1617 and that he became a citizen in 1618. He also joined the Separatist church there. While living in Leiden, many of the Pilgrims worked in the manufacturing of cloth. They did so not necessarily by choice: it was what was available to them. Dr. Jeremy D. Bangs has identified the occupations of 130 of them and a majority were weavers. In his

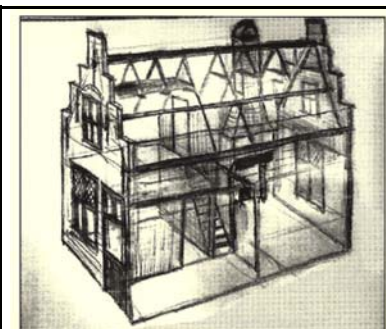

Two room weaver's house drawn by Jeremy D. Bangs, PhD

book *Strangers and Pilgrims, Travellers and Sojourners* he has described in detail what a Pilgrim weaver's two room house might have looked like and has provided this drawing.

The house that Rogers bought in 1671 was on Barbarasteeg (Barbara Alley). Based on its cost it apparently was only a one room house, not a two room house as

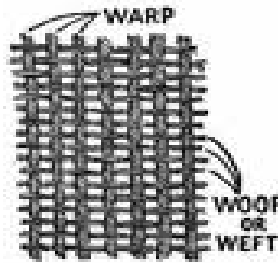

illustrated. He became a greyn weaver. Greyn was a fabric

with goat's hair warp (threads running the long way) and wool weft (threads running crosswise, also known as woof). On April 1, 1620, in preparation for his joining the other Pilgrims to sail for the New World, he sold his house and moved his wife and children, with the exception of son

Joseph, to a house on the corner of Pieterskerkhof and the Kloksteeg. The house still stands and, although altered in the 19th-century, is the only remaining Pilgrim house in Leiden. If you visit Leiden, Dr. Bangs can direct you to it.

Thomas Rogers and his elder son Joseph (c. 1603-c. 1678) joined the lucky ones who were able to fit aboard the *Mayflower*. He was a signer of the Mayflower Compact. There is no mention of him in the two major eye witness accounts of the first winter, the 1622 *Mourt's Relation* or Gov. Bradford's 1620-1647 history except that Bradford

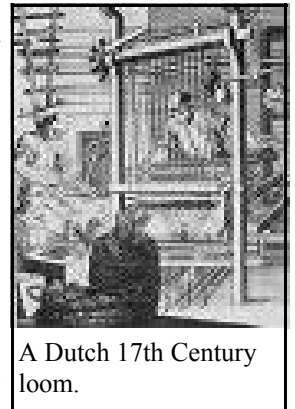

A Dutch 17th Century loom.



Home of widow Alice Cosford Thomas. The only surviving house in Leiden in which a Pilgrim lived. Photo by Jeremy D. Bangs, PhD

Continued on page 2

Continued from page 1

in his list of *Mayflower* passengers states "Thomas Rogers and Joseph his son; his other children came afterwards." In his account of "decreasings" and "increasings" that follow Bradford writes: "Thomas Rogers died in the first sickness but his son Joseph is still living [circa 1647] and is married and hath six children. The rest of Thomas Rogers' came over and are married and have many children." Two more children were born to Joseph and his wife Hannah. Son John married an Anna Churchman and they had four children. Thomas' two daughters Elizabeth and Margaret may have come to New England, married, and had children, but no descendants had been located by the Mayflower Society as of 2000.

Son Joseph eventually moved to Duxbury, operated a ferry and around 1647 moved to what is now Eastham on Cape Cod. He was appointed a Lieutenant in charge of the local militia and died in January 1678. He is buried in the Cove Burying Ground there and is memorialized by a large bolder with affixed bronze plaque reading "LIEUTANANT JOSEPH ROGERS / 1607 [sic] - 1678 / MAYFLOWER PASSENGER / COMMISSIONED PLYMOUTH / COLONY MILITIA. 16-67 / PLACED BY HIS DESCENDANTS / 1966".

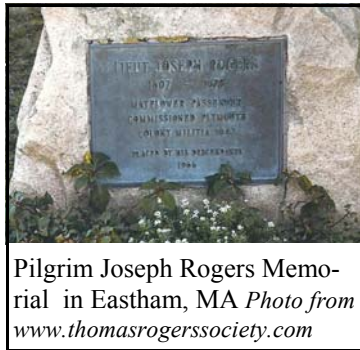

Pilgrim Joseph Rogers Memorial in Eastham, MA Photo from www.thomasrogerssociety.com

There are no known artifacts, wills, inventories, etc. for Thomas Rogers.

Notable descendants are said to include the Presidents Bush, Justice David Hackett Souter and ambassador, publisher, philanthropist and investor John Hay Whitney (1904-1982).

If you are a descendant write the name of the child of Thomas Rogers from who you descend here: _____.

About forty Pennsylvania members have claimed descent from Thomas Rogers to join during the our first 110 years. There are currently about 20 active descendants.

There is a Thomas Rogers Society with a website at <http://www.thomasrogerssociety.com>.

For information about 300 descendants through the first five generations and their children and in-laws see the Mayflower Society's Volume 19 published in 2000 compiled by Alice W.A. Westgate and revised by Ann T. Reeves in its series *Mayflower Families Through Five Generations*. You may find a copy in your local library. It is currently out of print and being revised.

PILGRIMS VISIT MAZIE GABLE ELEMEN-TARY SCHOOL - *Special to the JR PA Mayflower*

My name is Cora Wagner. I am a sixth grade student at Mazie Gable Elementary School, Red Lion, York Co., PA.



Plimoth Plantation colonial teachers Chris Messier and Vicki Oman with reporter Cora Wagner. Photo by Cora's grandfather John Dressel.

Some Pilgrims came into our sixth-grade classrooms to tell us about their life when they had to leave their home state and come to the New World.

The Pilgrim that came to our class was the female Pilgrim. She showed us what they had to eat on the *Mayflower*. They ate dried-up fish and biscuits. Most of the time the food was very hard instead of soft like the food we eat now.

Also she showed us some of the things that they had to wear for clothing. Some of the kids in my class got to wear the clothing she brought along with her. She had the little boy's outfit, the little girl's outfit and the baby's outfit.

She then told us how most of the people got sick while on the *Mayflower*. Some of the people even died from not having enough food and from not having enough warmth. They also had problems with not having enough space to spread out. She told us about how they didn't have any good bathrooms on the boat. They only had one bathroom and it didn't flush like ours do today. They had to do their business in a bucket in a room at the back of the boat. One of the crew members then had to dump the bucket off the top deck of the boat.

She told us that the babies went straight to beer when they were done breast feeding. Then she asked us if we drank beer and we told her that we didn't. That's what my class learned when a Pilgrim came to our class.

Editor's note: Since 1997 SMDPA has completely funded these annual visits to selected PA schools and over 22,000 students.

UNSCRAMBLE COLUMN ONE AND DRAW CONNECTING LINES TO THE RIGHT PICTURES

Dates indicate approximate first appearance in Plymouth.

A. WOC =

B. ACT =

C. GOH =

D. AFFIMST =

E. TOGA =

F. SHORE =

G. NEH =

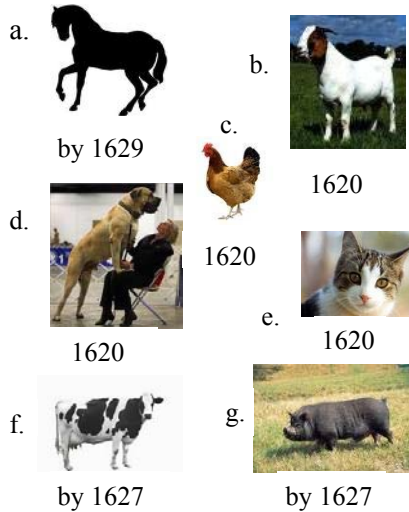

ANSWERS: A = f., B = e., C = d., D = g., E = a., F = b., G = c. (a Mastiff is a large dog).

WIDOW ALICE ROGERS NEEDS TO FIND HER WAY HOME TO HER LEIDEN HOUSE ON KLOKSTEEG. CAN YOU GUIDE HER HOME?

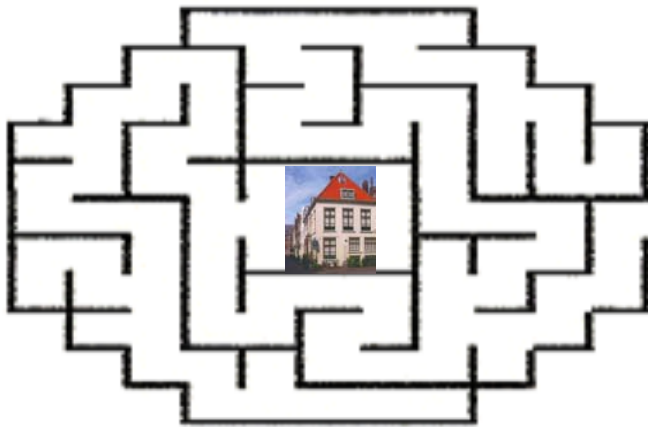

Pilgrim image courtesy Plimoth Plantation.

Any comments or suggested topics for the feature articles of this newsletter? Perhaps an article, puzzle or drawing for consideration? If so, please contact Stacy B. C. Wood, Jr., Editor, "JR PA Mayflower," 1530 South Juniper Street, Philadelphia, PA 19147-6218 or by e-mail at sbcwjr@comcast.net.

ANSWER: Unused letters from the 16 x 20 Thomas Rogers Wordsearch: "For the twelve years of true were now out."

THOMAS ROGERS 16 X 20 WORDSEARCH

ESUOHNOSSICKNESSLSFO
RRFTSDSAMOHTWATFORDE
IWINTE RHVCJERBTYOENZ
HGSWISPEECLOADRTMGAN
SRHVUCMAEU CRURRLOLO
NEAPCEYSRPEERE EAARLR
OYILSNPTIAEFRWNVWSOB
TNTAIDAHR TTIODOEAIHA
PFIQBASAHIPIZBILRENN
MCLUTNSMTORASALLFSWG
ALIEUTENANTUBTMECYES
HOMWESNEHDESAHCRUPAR
TTEESIGNERECORDSNOWM
RHGABLEHCRUHC COMPACTO
OWARPYRUBXUDROFSOCUT
NEDIELSPARISHMWAGNER

THOMAS ROGERS 16 X 20 WORDSEARCH

The following 51 words are found in this issue. The unused letters answer the question "What was a reason for leaving Holland?" The words: BANGS, BAPTISMS, BARBARASTEEG, BATHROOM, BISCUITS, BRONZE, CHURCH, CLOTH, COMPACT, CORA, COSFORD, COVE, DESCENDANTS, DRAWING, DUXBURY, EASTHAM, ENGLAND, FERRY, FISH, GABLE, GREYN, HATH, HOLLAND, HOUSE, LEIDEN, LIEUTENANT, LION, LOOM, MAYFLOWER, MAZIE, MILITIA, NORTHAMPTONSHIRE, OCCUPATION, PARISH, PASSENGERS, PLAQUE, PURCHASED, RECORDS, ROGERS, SEPARATIST, SICKNESS, SIGNER, SOJOURNERS, SON, THOMAS, TRAVELLERS, WAGNER, WARP, WATFORD, WEAVER, WINTER.

DIFFICULTY



Greyn is hair from this goat!

9x9 grid with some letters filled in: R S D, H R, G E D, D G E T A H R, A, H G, G T H R S D O, S O E T, T G R H

The Goat Sudoku puzzle uses nine non-repeating letters of two joined words. The answer is below.

9x9 grid with letters: H V R S G E T D O, T G T V O D E S R H, O S D O T H R S E A G, G O S G E O A E H T R, E O A G R H D T E, H R S T A R O S E O, R D S O H E A T R D, A H D R T O G E S, T E R S D G H O A

GOAT SUDOKU CLUES: One column or row spells the keyword in the clear.

A PAGE TO COLOR

Here is the street in Leiden, Holland where Thomas Rogers' wife and three children lived before coming to Plymouth Colony. John Robinson was the Pilgrims' pastor and he died before he could join the Pilgrims in New England.

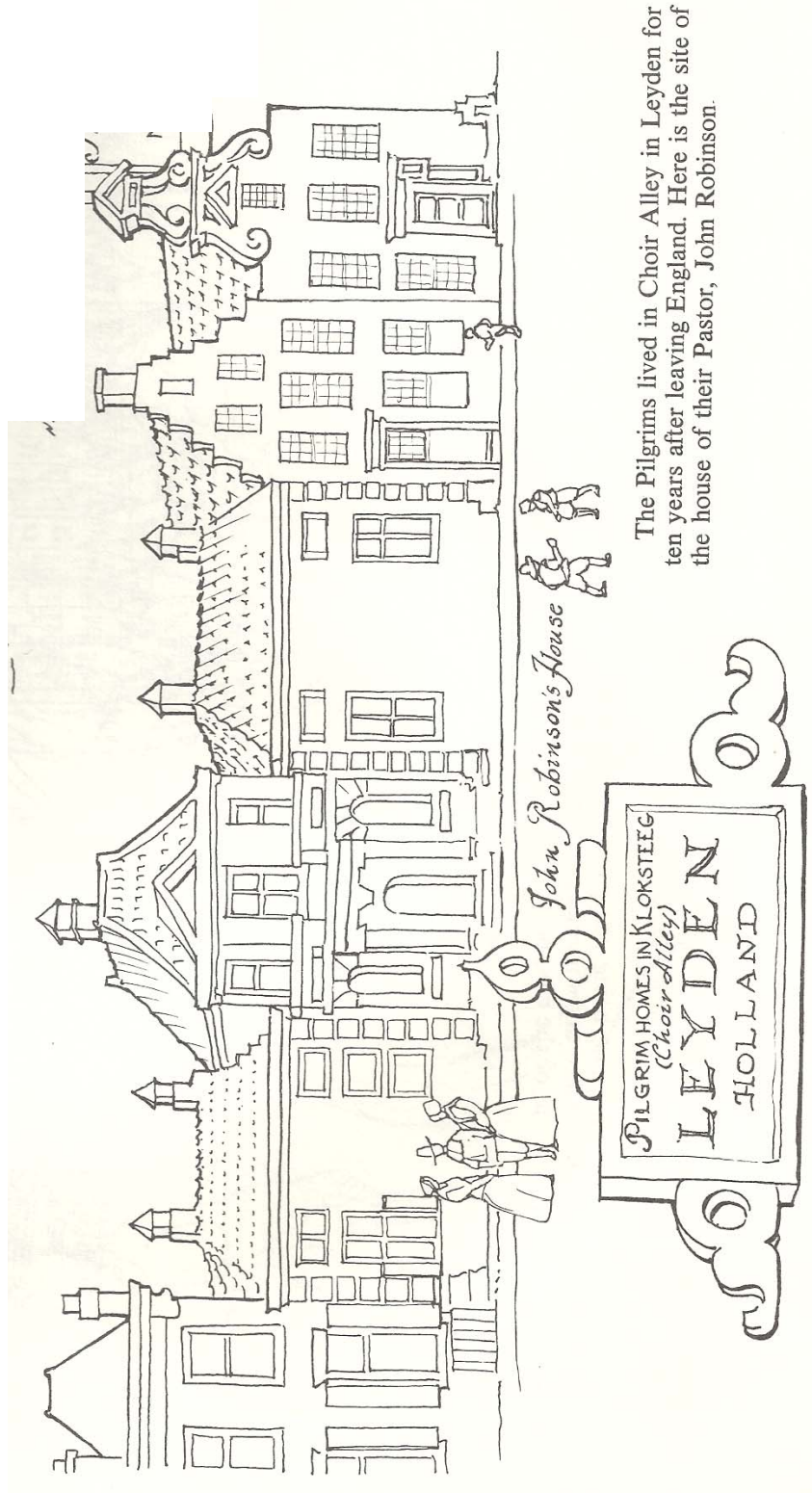

From: "The Pilgrim Story - A Picture Book for Coloring" by Charles H. Overly (1963). Courtesy of Plimoth Plantation.